

Kabel/Salon

Maestro



%100 The Comfort

User Guide

1. indice

IMPORTANT INSTRUCTIONS.....	3
DEVICE DIAGRAM	3
INSTRUCTIONS FOR.....	4
REMOTE CONTROL OPERATION.....	4
CONTROL PANEL.....	5
CLEANING METHODS OPERATION.....	6
STORAGE INSTRUCTIONS..	7
NOTICE.....	7
INSTRUCTIONS FOR USE.....	8
TECHNICAL PARAMETERS.....	9
SCHEMATIC DIAGRAM.....	9
INSTRUCTIONS FOR USE.....	10
CERTIFICATE OF GUARANTEE.....	11

IMPORTANT INSTRUCTIONS

- The device must not be used in completely enclosed environments. If it is to be used, doors and/or windows must be kept open. The user should pay attention to the following. The distance between the air inlet of the appliance and the doors and/or windows must be 10-20 cm.
- The network voltage must be 5% lower than the nominal voltage. A low tension may cause the fan to stop working. In the long term, low voltage or cold can damage the machine.
- Before starting the appliance in cooling mode, water must be added to the water tank. Otherwise, it will not cool down and will issue a warning.

DEVICE DIAGRAM

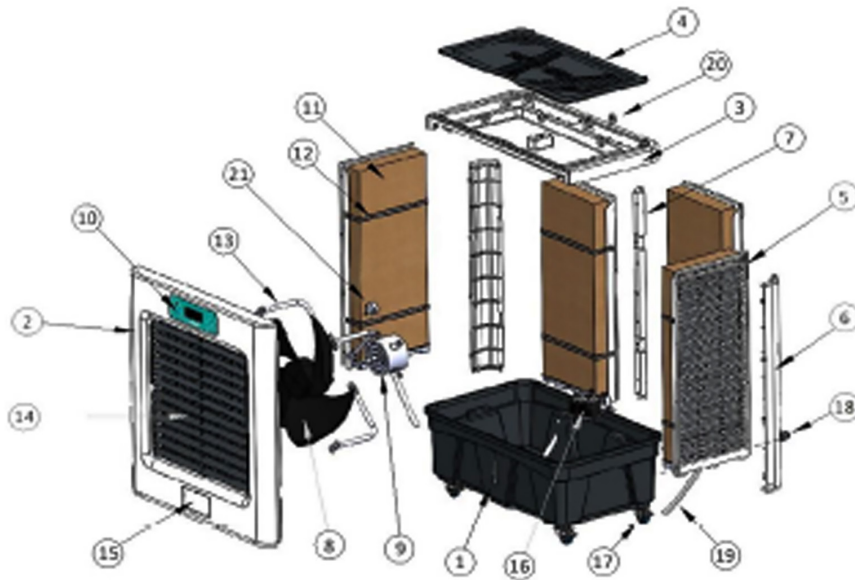

NO	TRACK NAME	NO	TRACK NAME	NO	TRACK NAME
1	Water tank	8	Fan	15	Water inlet cover
2	Display	9	Engine	16	Water Pump
3	Separador	10	Main board	17	Wheels
4	Top deck	11	Cooling pad	18	Drainage equipment
5	Side panel	12	Cooling pad holder	19	Set of water tank for pads
6	Cornerback	13	Motor foot	20	Pressure cap
7	Center post	14	Set of wings	21	Tilting motor

3. INSTRUCTIONS FOR

3.1 REMOTE CONTROL OPERATION

1- ON/OFF

When plugged in, the device powers up and is in ready-to-go mode. When this button is pressed, the device starts to work at low speed. Turns off when pressed again.

2- Cold

When this button is pressed, the cooling mode is activated. At first start-up, cooling mode is activated 20 seconds after pressing this button.

3- High & Middle & Low

These buttons are used to set the speed level. One of 3 speed levels can be set by choosing between these buttons.

4- Vent

When this button is pressed, the cooling mode is disabled. Ventilation mode is activated.

5- Swing

When this button is pressed, the vertical louvers rotate left and right. Pressing it again turns the mode off.

6- Backlight

When this button is pressed, the display lights turn off. Lights up when pressed again.

7- Time

When this button is pressed, the working time can be determined.

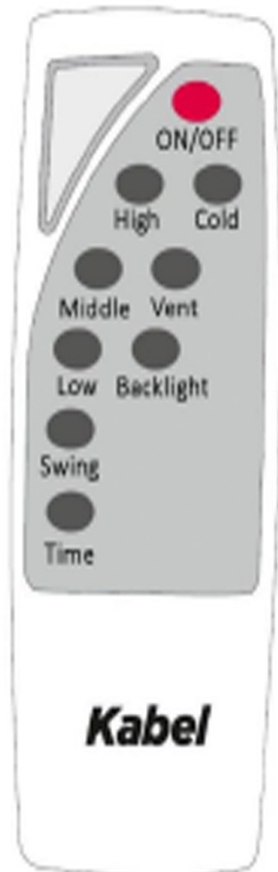

3.2 CONTROL PANEL

1- ON/OFF

When the ON/OFF button is pressed while the plug is plugged in, the device starts to work.

When the ON/OFF button is in power-on mode, it maintains the current operating conditions when the device is turned off and on again. In any operating mode, the cooler can be turned off by pressing this button.

2- COOL

When the Cool button is pressed, the device switches to cooling mode. When it is pressed again, the cooling mode is deactivated, it is changed to the ventilation mode.

3- SWING

When this button is pressed, the vertical louvers rotate left and right. Pressing it again turns the mode off.

4 -SPEED

With this button, the fan speed level is determined. It works on 3 levels. When pressed again, it returns to the beginning.

5- WIND FUNCTION

Each time this key is pressed, it switches between modes. It works in 3 modes: standard mode, natural mode and night mode..

6- BACKLIGHT

When this button is pressed, the display light turns off. Lights up when pressed again.

7 -TIMER

When this button is pressed, the working time can be determined.



4. CLEANING METHODS OPERATION

Since the appliance is cooled with water, the water tank, cooling pads and filters should be cleaned to maintain peak performance, especially after one use.

dragged on. This cleaning also prevents the formation of bad odors, etc.

The appliance must be maintained and cleaned every 2 weeks to prevent these situations and avoid damage caused by contamination.

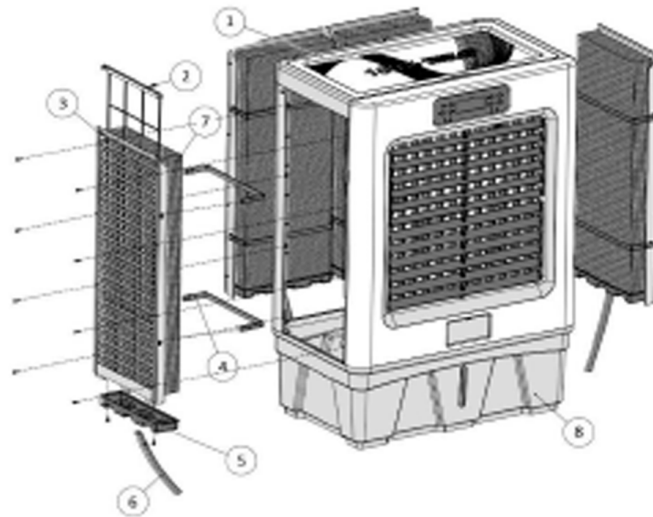

1- Separator Cleaning

The part of the top cover numbered in the diagram above opens. The retractor holes can be cleaned from time to time with a sharp object. Water mixed with lemon salt can be poured into the upper chamber to remove limescale.

Since the quality of the water used varies, the water distribution channels can be checked by opening the top cover from time to time.

2- Dust filter cleaning

The filters indicated with the number 2 in the above diagram are removed by pulling upwards. They are cleaned by washing them with pressurized water.

As appliance operating environments vary, the condition of the dust filters may be checked from time to time.

3-Cleaning cooling pads

*The part of the side panel numbered 3 indicated in the diagram is removed by unscrewing the screws.

* The panel support plastics numbered 4 are removed from the slot and the cooling panel is accessed. It is recommended to clean the cooling panel with pressurized water.

*The water tank on panel number 5 is removed by unscrewing the screws and cleaned.

* The number 6 water hose is removed and cleaned by removing the Screws.

4- Body Cleansing

The body can be cleaned with water without disassembling the appliance. The part of the water tank number 8 is washed with water. In case of possible lime, the use of lemon salt will ensure the removal of lime.

NOTE!!!*** Unplug the appliance during the cleaning process.

*** Before and after cleaning, the parts of the CONTROL PANEL must NOT be wet.

5. STORAGE INSTRUCTIONS

If the appliance is not going to be used for a long time, empty and clean the water in the tank. Make sure cooling pads and other parts are completely dry before packing. Damp packaging can cause bad odours.

6. NOTICE

1. For safety reasons, remove the plug from the power socket before filling the tank with water.
2. To avoid electric shock, do not disconnect the plug from the outlet when your hands are wet.
3. Use plugs that meet the conditions of 220 V- 50 Hz, the standard National Safety Rating is 3A and below.

6. INSTRUCTIONS FOR USE

1. If the appliance is not going to be used for a long time, please unplug it to avoid electrical failure.
2. Disconnect power supply during cleaning, maintenance and moving.
3. The cooling pads should be placed in the specified places inside the appliance. Otherwise, this will affect the service life and operating performance.
4. To avoid injury and accident, keep foreign objects and hands and arms out of the appliance while the fan is running.
5. Do not use the appliance in the presence of flammable and explosive gases or in direct sunlight. Do not place anything on top of the appliance. Do not block the air inlet or outlet. Keep away from other objects while the appliance is in operation.
7. The appliance must be used on a horizontal surface. To avoid falls and malfunctions, do not use it on uneven ground.
8. Do not move the appliance when the water tank is full to avoid water overflow.
9. To avoid accidents, do not turn the appliance over when there is water inside. If the water overflows, Disconnect the plug from the outlet and allow to dry for 24 hours. Note: Pour the water into the tank slowly.
10. Do not use the appliance in wet areas such as swimming pools, bathrooms, etc.
11. The water level should match the level indicator on the water tank.
12. Do not use the appliance in completely closed environments. Leave windows and/or doors open during use. Otherwise, the airflow may be negatively affected.
13. This device has a strong moisturizing effect, do not use it indoors.
14. Empty the water if the appliance is not used for a long period of time to avoid bad smell.
16. Water must be completely drained before packing or transporting.
Pack the cooling pads after making sure they are completely dry to avoid bad odours.
17. If there is an electrical fault in the appliance, it must be repaired by a professional team.
18. People other than our professional teams are not authorized to repair and maintain the device. If it is done, it will be out of warranty.
19. This appliance should not be used by weak, irresponsible or handicapped people neurological diseases without someone guaranteeing their safety.
20. Use the appliance near doors and/or windows.

7. TECHNICAL PARAMETERS

Guy	Flow m ³ /h	Voltage	Power W	Water capacityL	Dimensions MM	Net weight KG	Sound DSB
Kabel Salon Maestro	8000	220 V 50 Hz	310	65	875x540x1350	40	<76

8. SCHEMATIC DIAGRAM

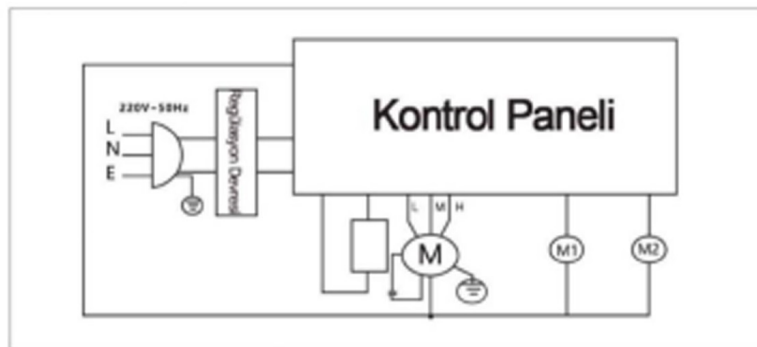

6. INSTRUCTIONS FOR USE

Problem	Reason	Proposed Solution
The appliance does not cool	<ol style="list-style-type: none"> 1. Faulty water pump or level sensor 2. Calcification of the pads 3. Incomplete wetting of pads 4. Not to be used in open and semi-open areas 	<ol style="list-style-type: none"> 1. Check the connection of the motherboard, the operation of the water pump level. 2. The pads and filters need to be cleaned regularly. 3. The holes in the separator should be cleaned periodically. 4. When the appliance is in cooling mode, it should not be used indoors.
The appliance is very humid	<ol style="list-style-type: none"> 2. Calcification of the pads 	<ol style="list-style-type: none"> 1. When the device is in cooling mode; It should be used in open and semi-open areas. 2. The performance of the device may vary depending on the climatic conditions of the region.
The device is very noisy	<ol style="list-style-type: none"> 3. Incomplete wetting of pads 	<ol style="list-style-type: none"> 1. Fan change done 2. The hoses in the water to the water tank should be checked. 3. The connection of the water inlet cover should be checked 4. Installation of vent blades should be verified
The device is not receiving power	<ol style="list-style-type: none"> 4. Not to be used in open and semi-open areas 	<ol style="list-style-type: none"> 1. The fuse may be damaged due to voltage fluctuation. The operation of the motherboard should be checked by replacing the fuse. 2. The motherboard needs to be replaced
Indicator lights on, fan not working	<ol style="list-style-type: none"> 1. Engine failure 2. Display failure 	<ol style="list-style-type: none"> 1. Clogged pads block airflow and stress the motor. The motor needs to be replaced 2. The display must be replaced
Water leaks from the appliance	<ol style="list-style-type: none"> 1. Calcification of the pads 2. Calcification of the separator 	<ol style="list-style-type: none"> 1. Dust pads and filters should be cleaned at regular intervals to remove limescale. 2. It must be cleaned at regular intervals.
Smell coming from device	<ol style="list-style-type: none"> 1. Do not change the water for a long time 	<ol style="list-style-type: none"> 1. The water in the water tank should be changed frequently

CERTIFICATE OF GUARANTEE

OPENER:

Qualification: Alindair Soğutma Sistemleri San. ve Tk. AŞ.

Address: Pınarkent Mah. 210 Sok. No:3
Pamukkale/ DENİZLİ

Phone: 0258 268 0056

Fax: 0258 261 34 89

e-mail: info@alindair.com.tr

Signature of authorized person:

Company seal:

Empresa vendedora:

Qualification:

Address:

Phone:

Fax:

email:

Date and invoice number:

Date and place of delivery:

Signature of authorized person:

Company seal:

PRODUCT

Guy: Enfriador Evaporativo

Brand: Kabel

Model: Salon Maestro

Warranty period: 2 Years

Maximum repair time: 30 working days Banderole and serial number

WARRANTY CONDITIONS

- 1) The warranty period begins from the date of delivery of the merchandise and is 2 years.
- 2) All parts of the merchandise, including all parts, are covered by the warranty.
- 3) In case it is understood that the goods are defective, the consumer will have the rights established in article 11 of Law No. 6502 on Consumer Protection,
 - a- Asking for a discount on the sale price,
 - b- Asking for a discount on the sale price,
 - c- Do not ask for free repairs,
 - ç- To request the replacement of the Shahlan with an equivalent without defects, you can use one of the rights.
- 4) If the consumer chooses the right to free repair among these rights, the seller is obliged to repair or have the item repaired free of charge under the denomination of labor cost, spare part cost or any other denomination. The consumer can also exercise the right to free repair against the manufacturer or importer. The seller, the manufacturer and the importer are jointly responsible for the exercise of this right by the consumer.
- 5) If the consumer exercises the right to free repair, the goods;
 - New failure within the warranty period,
 - Exceeding the maximum time necessary for repair,
 - In cases where it is determined in a report from the authorized service station, the seller, the manufacturer or the importer that the repair is not possible;The consumer may ask the seller to refund the price of the goods, to discount the price in proportion to the defect or, if possible, to replace the goods with an equivalent without defects. The seller cannot reject the consumer's request. If this request is not met, the seller, the manufacturer and the importer are jointly and severally liable.
- 6) The maximum period of repair of the goods will not exceed 30 working days. This period starts from the date of notification of the defect related to the merchandise to the authorized service or the seller within the warranty period, or from the date of delivery of the merchandise to the authorized service outside the warranty period.
- 7) The guarantee does not cover failures caused by user errors or failure to comply with the 30-day periodic maintenance of the products.
- 8) The consumer may go to the Consumer Arbitration Commission or the Consumer Court of the place where they are domiciled or the consumer transaction is carried out in case of disputes that may arise in relation to the exercise of their rights derived from the guarantee.